



# SPECIFICATION

Part No. : **GW.26. 0151**

Product Name : 2.4GHz Miniature Screw mount Dipole Antenna

Description : SMA Reverse Male Connector  
Length  $30.3 \pm 1\text{mm}$   
**ROHS Compliant**



## REVISION STATUS

Version	Date	Page	Revision Description	Prepared	Approved
01	Jun 16 <sup>th</sup> 2009	All	New product	TW Product Centre	Ronan Quinlan



## Specification

### 1.0 Introduction

The GW.26 2.4 GHz dipole reverse SMA plug mount antenna is ideal for 2.4 GHz wireless applications such as Bluetooth and Wireless LAN. Connector mount is fully customizable.

### 2.0 Electrical Properties

1.1	Frequency	2.4 GHz ~ 2.483 GHz
1.2	Gain (peak)	<0 dB Peak
1.3	V.S.W.R	<2.0 Max
1.4	Radiation	Omni-directional
1.5	Polarization	Vertical
1.6	Power Handling	1W Max
1.7	Electrical Wave	$\frac{1}{2} \lambda$ : Dipole
1.8	Impedance	50 $\Omega$
1.9	Operating Temperature	-40°C ~ +85°C

### 3.0 Mechanical Properties

2.1	Color	Black and Green
2.2	Connector	SMA Plug Reverse



## 4.0 Outline Drawings and Structure

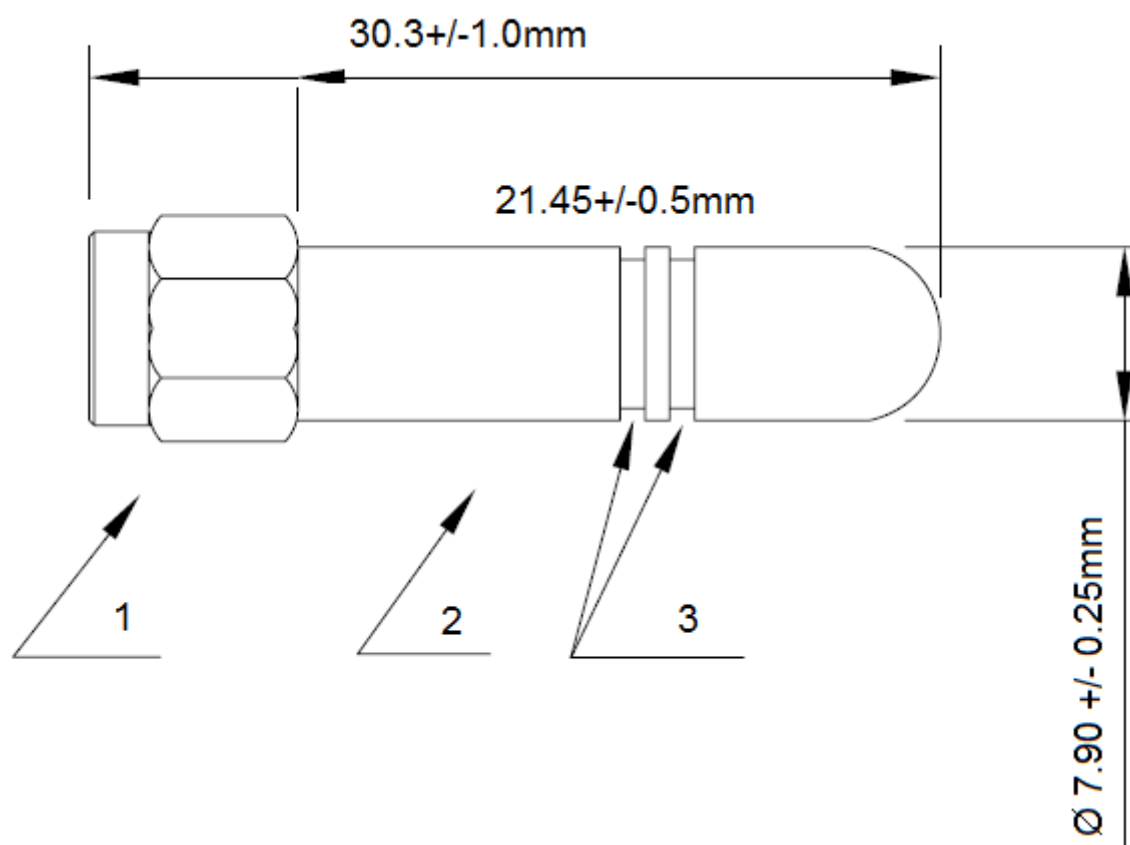

### Key

1	Connector	RP-SMA Brass
2	Antenna Cover	TPU (Black)
3	Colour Stripes	Apple Green



## 5.0 Measurements

### 5.1 VSWR





Specification

## 5.2 Return Loss (S11 Mag.)

